



Rooftop Support Systems
by Clearline Technologies

CZ Series



CZ Seismic Series is designed for support of gas and refrigeration piping systems, cable tray, electrical conduit, multiple lines, HVAC equipment and many other applications. This is a penetrating support fastened to the structure under the membrane. It is ideally designed for hurricane resistance or seismic applications. The CZ Series is suitable for most types of roofing material or other flat surfaces.

- Max Load** 750 lbs
- Warranty** 10 years
- Recommended Spacing** Refer to local code
- May qualify for L.E.E.D. credits**

Available in corrosion resistant stainless steel or aluminum.

Material

- Base – 100% Recycled Rubber, UV Resistant
- Strut – 14 gauge Galvanized Channel strut (13/16" high)
- Rod – Two 1/2" electro-zinc plated all threaded rod risers

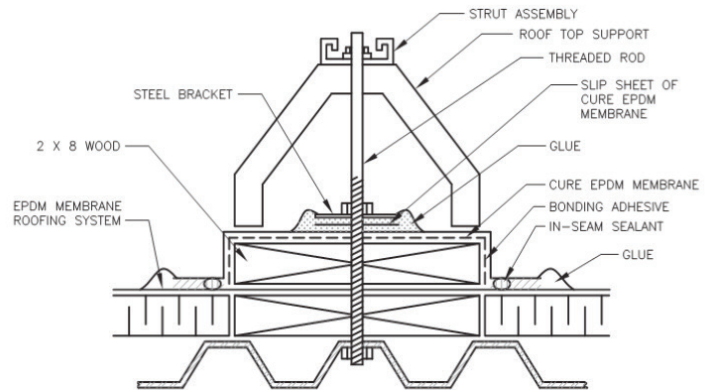

SKU	HEIGHT	WIDTH	LENGTH	WEIGHT
CZ10	478" (124mm)	6" (152mm)	9.6" (244mm)	5.9 lbs
CZ20	478" (124mm)	6" (152mm)	19.2" (487mm)	11.83 lbs
CZ30	478" (124mm)	6" (152mm)	28.8" (731mm)	16.91 lbs
CZ40	478" (124mm)	6" (152mm)	38.5" (978mm)	22.23 lbs

WWW.C-PORT.NET

1-866-444-0009

